

PUMP

3002619 - 3007803

3020476 - 3020475

ENGLISH

The pump is supplied for use with a one pipe system.
For use on a two pipe system, it is necessary to **screw the by-pass screw (A) (Fig. 1)**.

Set the pump pressure as described in the burner's instruction.



Power must be cut off before carrying out any installation, maintenance or removal operation.



In case the pump is replaced, block it with the 3 screws **(A)**, tightening them uniformly to a recommended torque of 3 ± 0.3 Nm, then replace the coupling **(B)** supplied with the equipment **(Fig. 2)**.

Before you begin to use your new Riello oil pump, please check the condition of the removed oil pump for contamination as this may be the reason for the existing pump failure. If so then your new pump may also fail for the same reason. You can check for contamination of the removed pump by slackening and then removing the 4 x fixing screws **(C) (Fig. 2)** of the pump cover and checking the condition of the oil filter inside. If there are signs of contamination on the inner surfaces of pump body, cover or filter then it is likely that the oil storage is contaminated and this will require corrective actions (cleaning) **BEFORE** you begin to use a new pump. Riello also recommends the use of a good quality oil filter (with a filtering capacity of 15 micron max.) to be installed within the oil supply line.

NOTE: Contaminated or damaged oil pumps are not covered under the terms and conditions of Riello warranty!

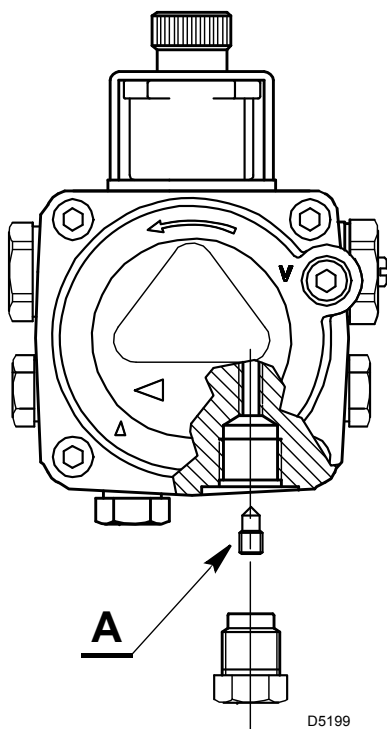

Fig. 1

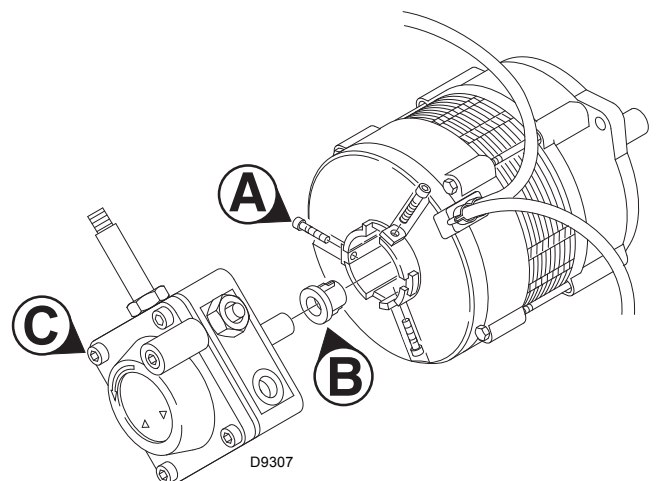
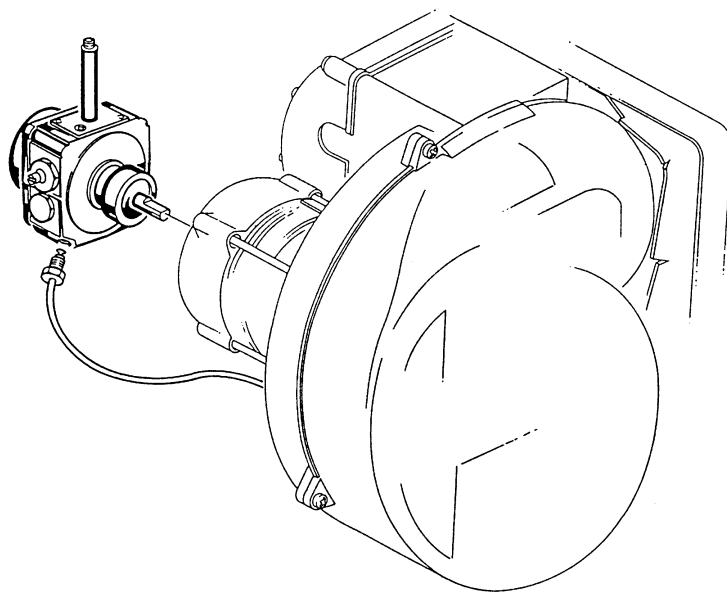
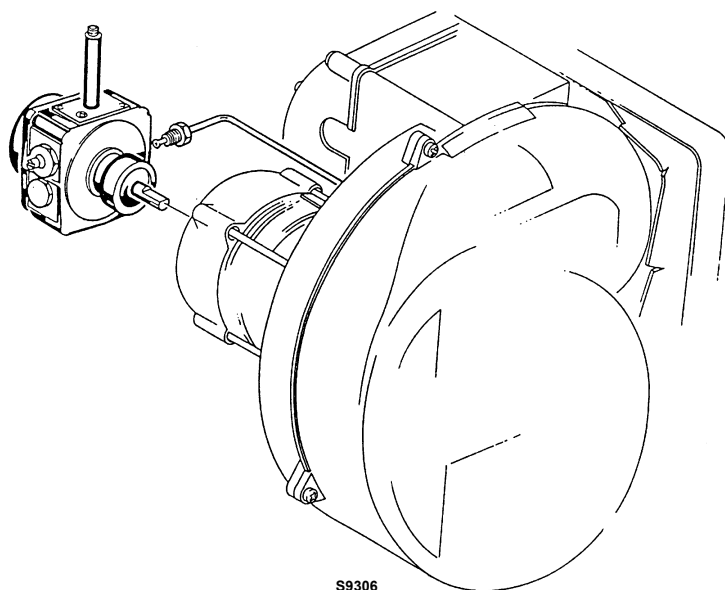
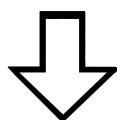

Fig. 2

PUMP REPLACEMENT



OLD PUMP



NEW PUMP

S9306

Fig. / Abb. 3